

REV	SHT	ZONE	REVISION DESCRIPTION	LOG NO.	REV BY	CHK BY	APPD BY	DATE YYYY-MM-DD
B			REPLACEMENT CONTROLLER P/N CHANGED	16-R116	AMB			

**NOTES:**

1. VALIDATED FLOW FOR USEPA 4-LOG VIRUS PROTOCOL
2. THIS SYSTEM HAS BEEN INVESTIGATED BY UL IN ACCORDANCE WITH:
  - UL 979-STANDARD FOR WATER TREATMENT APPLIANCES
  - CAN/CSA C22.2 No. 68-09-STANDARD FOR MOTOR -OPERATED APPLIANCES (HOUSEHOLD AND COMMERCIAL)
3. THIS SYSTEM USES ALL RoHS CERTIFIED MATERIALS
4. THIS SYSTEM HAS BEEN BUILT IN ACCORDANCE TO NSF/ANSI 61 ANNEX G FOR LOW LEAD
5. THE LAMPS USED IN THIS SYSTEM ARE IMERC REGISTERED

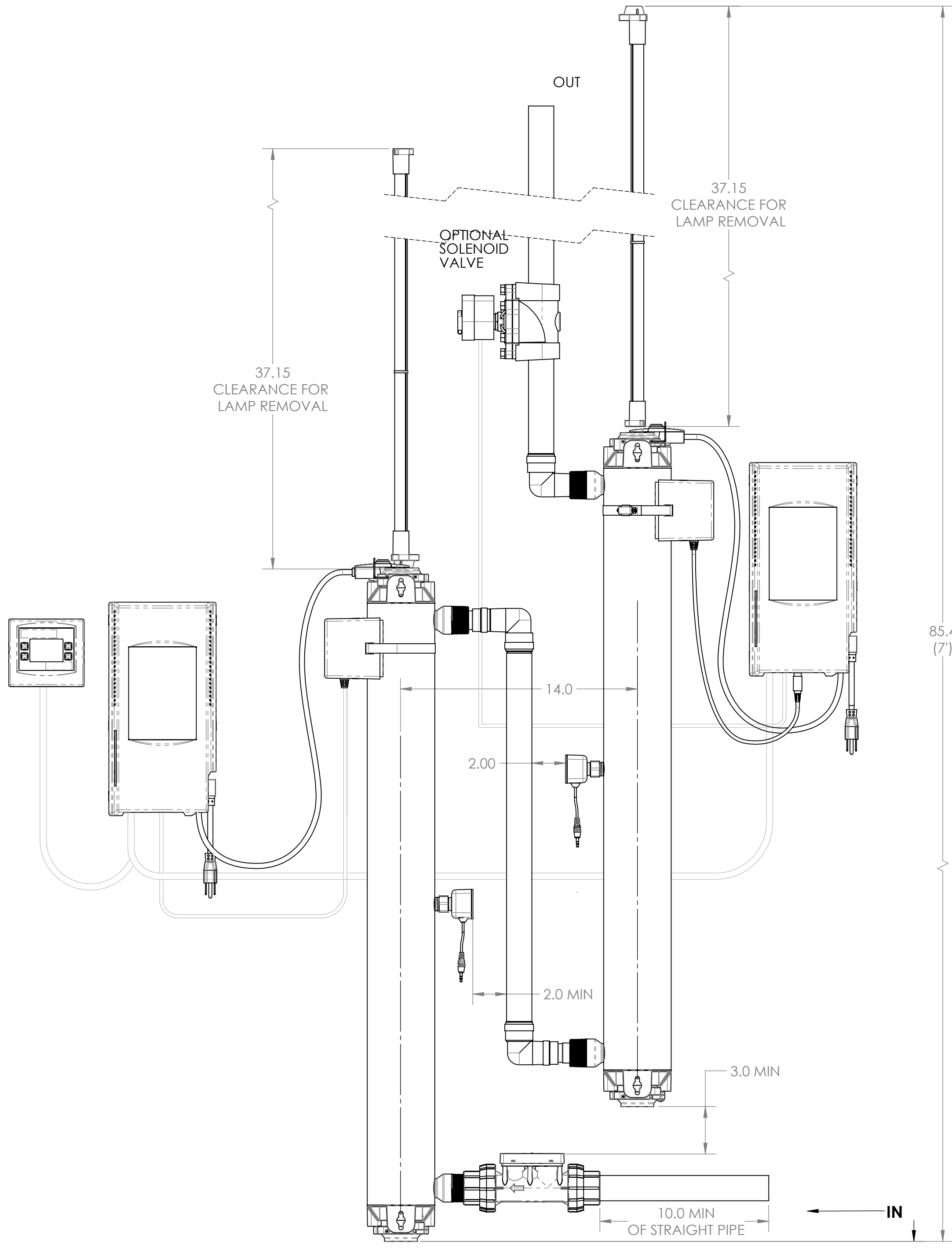

<p><b>UNLESS OTHERWISE SPECIFIED:</b> DO NOT SCALE DRAWING INTERPRET DIMENSIONS AND TOLERANCES PER ASME Y14.5M-2009 DIMENSIONS ARE IN INCHES TOLERANCES APPLY AS SHOWN BELOW: 2 PL DEC ± 0.01 3 PL DEC ± 0.005 ANGLE ± 0.5° REMOVE ALL BURRS, ALL CORNERS R 0.010" OR BREAK EDGE.  CRITICAL CHARACTERISTIC</p> <p>THIRD ANGLE PROJECTION</p>	<p>COPYRIGHT BY VIQUA. ALL RIGHTS RESERVED.</p>	<p><b>VIQUA</b> A TROJAN TECHNOLOGIES BUSINESS 425 CLAIR ROAD WEST, GUELPH, ONTARIO, CANADA, N1L-1R1 DESCRIPTION: SYS, PRO 24GPM @ 186mJ/cm2</p>
	<p>Drawn by: AMB Created on: 2015-06-23 Release log #: 16-R061</p>	

REV	SHT	ZONE	REVISION DESCRIPTION	LOG NO.	REV BY	CHK BY	APPD BY	DATE YYYY-MM-DD
B			REPLACEMENT CONTROLLER P/N CHANGED	16-R116	AMB	AMB	AMB	2016-03-23

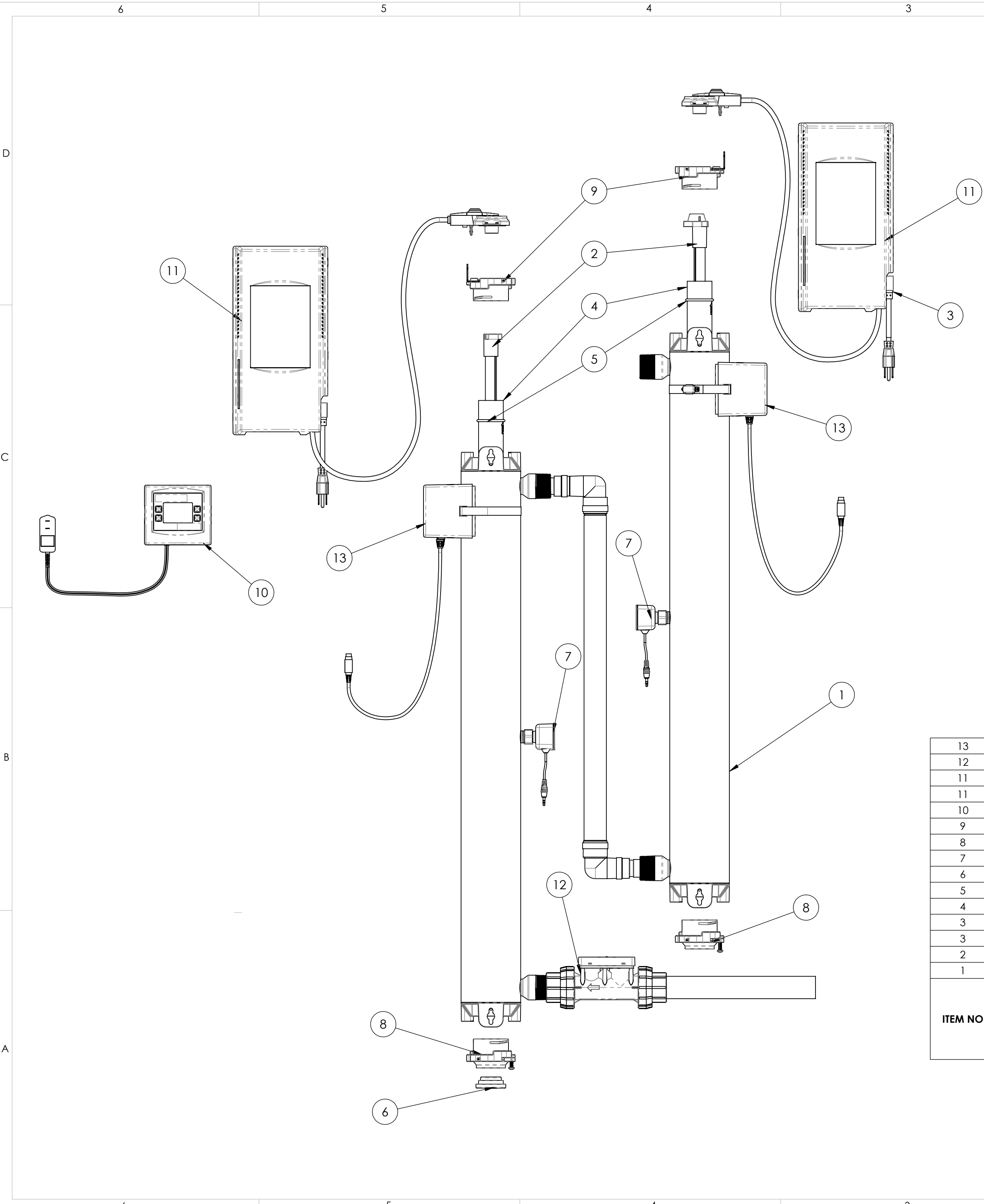

ITEM NO	660086-R/QTY.	660087-R/QTY.	ITEM DESCRIPTION	PART NO.	DRAWING NO.
13	2	2	COOLTOUCH KIT, UVMAX GEN2	650630	650568
12	1	1	SENSOR, FLOW METER GPM	410982R-30	410982RG
11	1	1	PS KIT, 120/240V UVM G2 PRO30	650629-030	650629G
11	1	1	PS KIT, 120/240V UVM G2 PRO30	650629-030	650629G
10	1	1	COMM CENTER ASSY, VIQUA	270288-R	270288-R
9	2	2	BOLT, SLEEVE UVMAX GEN 2	602916	602916
8	2	2	SLEEVE BOLT ASSY, UVMAX G2 RS	603053	603053
7	2	2	SENSOR ASSY, PRO	270281-R	270281RG
6	1	1	TOOL, SLEEVE REMOVAL	602988	602988
5	4	4	O-RING, 1.61 X 0.13 EPDM	002211-223	002211G
4	2	2	SLV, REPL UVMAX J/PRO 30 PKGD	602976	602910G
3	2	-	CORD, POWER 120V 90DEG	602636	602636
3	-	2	CORD, POWER 230V 90DEG	602637	602637
2	2	2	LAMP, REPL UVMAX J/PRO30 PKGD	602856	602850G
1	2	2	CHAMBER, UVM G2 30+, 1/4"x1" RS	650634-006	650634G

**UNLESS OTHERWISE SPECIFIED:**  
DO NOT SCALE DRAWING  
INTERPRET DIMENSIONS AND TOLERANCES PER ASME Y14.5M-2009  
DIMENSIONS ARE IN INCHES  
TOLERANCES APPLY AS SHOWN BELOW:  
2 PL DEC ± 0.01  
3 PL DEC ± 0.005  
ANGLE ± 0.5°  
REMOVE ALL BURRS, ALL CORNERS R 0.010" OR BREAK EDGE. CRITICAL CHARACTERISTIC

THIRD ANGLE PROJECTION

COPYRIGHT BY VIQUA. ALL RIGHTS RESERVED.

**VIQUA**  
A TROJAN TECHNOLOGIES BUSINESS  
425 CLAIR ROAD WEST, GUELPH, ONTARIO, CANADA, N1L-1R1

DESCRIPTION  
**SYS, PRO24-186 120VAC**

DRAWN BY: AMB  
CREATED ON: 2015-06-23  
RELEASE LOG #: 16-R061

DWG NO.: 660086RG  
REVISION: B

MASS: 65.41 Kgs  
SCALE: 1:16  
SHEET 2 OF 2  
SIZE C